



US00D654826S

(12) **United States Design Patent**  
**Klinker**

(10) **Patent No.:** **US D654,826 S**

(45) **Date of Patent:** **\*\* Feb. 28, 2012**

(54) **RELIGIOUS ORNAMENT**

(76) Inventor: **Joseph Klinker**, Underwood, MN (US)

(\*\*) Term: **14 Years**

(21) Appl. No.: **29/401,635**

(22) Filed: **Sep. 13, 2011**

(51) **LOC (9) Cl.** ..... **11-03**

(52) **U.S. Cl.** ..... **D11/96**

(58) **Field of Classification Search** ..... D11/95-99,  
D11/116, 184, 1, 86, 40, 79, 81-82, 162,  
D11/157-158, 131, 66, 100, 103-104, 107,  
D11/13, 133, 172, 25, 41, 43, 48, 50, 58,  
D11/11; 63/1.11, 1.12, 1.13, 1.14, 1.16,  
63/1.18, 13, 14.1, 35, 39; D8/356

See application file for complete search history.

D436,329 S 1/2001 Sheridan  
D436,552 S \* 1/2001 Sheridan ..... D11/158  
D437,568 S \* 2/2001 De Clerico et al. .... D11/158  
D448,276 S \* 9/2001 Kelleghan ..... D8/356  
D484,433 S 12/2003 Moody  
D527,303 S \* 8/2006 Cavness ..... D11/157  
D527,677 S \* 9/2006 Cavness ..... D11/158  
D570,242 S \* 6/2008 Howle, III ..... D11/50  
D586,686 S \* 2/2009 Bell ..... D11/82  
D599,246 S \* 9/2009 Rudes ..... D11/103  
D605,546 S \* 12/2009 Castaline et al. .... D11/82  
D626,880 S \* 11/2010 Castaline et al. .... D11/82  
D631,781 S \* 2/2011 Mogren ..... D11/96

\* cited by examiner

*Primary Examiner* — T. Chase Nelson

*Assistant Examiner* — Mark Cavanna

(74) *Attorney, Agent, or Firm* — Daniel Boudwin;  
Alexander Boyer

(56) **References Cited**

**U.S. PATENT DOCUMENTS**

D200,870 S \* 4/1965 Simpson ..... D11/82  
D220,701 S \* 5/1971 Honzik ..... D11/81  
D238,811 S \* 2/1976 Ziglar et al. .... D11/48  
D252,387 S \* 7/1979 Lawrence ..... D11/131  
D314,728 S \* 2/1991 Wick ..... D11/50  
D382,226 S \* 8/1997 Howard ..... D11/100  
D391,192 S 2/1998 Speedling  
D392,917 S \* 3/1998 Cliff ..... D11/131  
D401,883 S \* 12/1998 Madhvani ..... D11/81  
D415,715 S \* 10/1999 Cliff ..... D11/162  
D420,177 S 2/2000 Jones  
D432,458 S \* 10/2000 Cliff ..... D11/162

(57) **CLAIM**

The ornamental design for religious ornament, as shown and described.

**DESCRIPTION**

FIG. 1 is a front view of a religious ornament showing my new design;  
FIG. 2 is an end view thereof; and,  
FIG. 3 is an underside perspective view thereof.

**1 Claim, 2 Drawing Sheets**

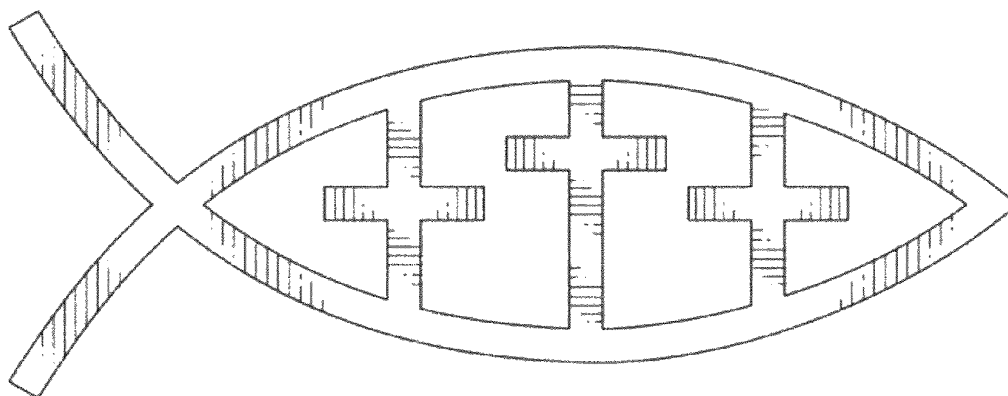



FIG. 2

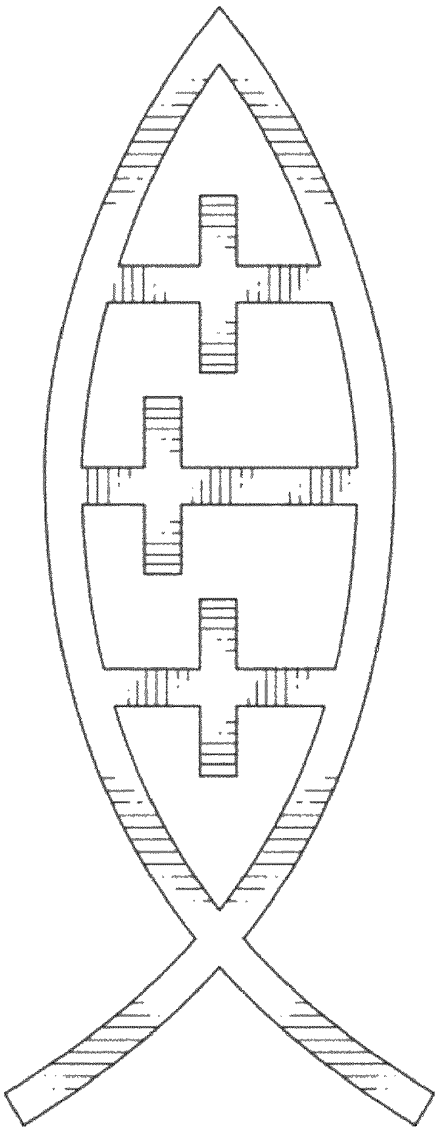

FIG. 1

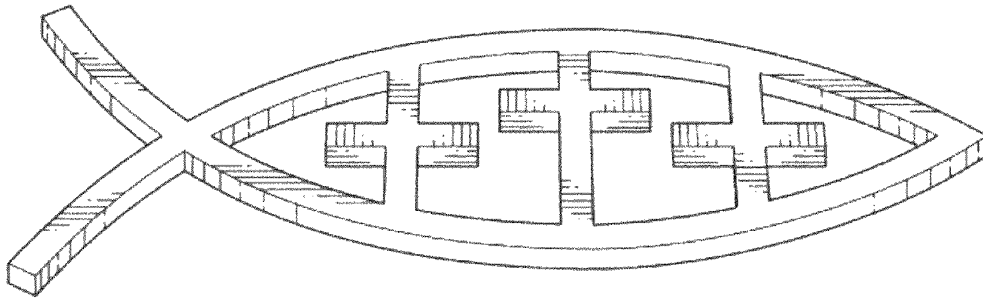

FIG. 3